

**DEPARTMENT FOR REGIONAL DEVELOPMENT**

**NORTHERN KEY TRANSPORT CORRIDOR**

**T7/M2 (A26) BALLEE ROAD EAST TO (M2) BALLYMENA BYPASS  
DUALLING SCHEME**

**(in the townlands of Ballylesson, Ballycreggy and Ballykeel, County Antrim)**

**NOTICE OF INTENTION TO MAKE A VESTING ORDER**

The Department for Regional Development proposes to make an order vesting certain lands in the townlands of Ballylesson and Ballycreggy, County Antrim in the Department under the Local Government Act (Northern Ireland) 1972 and the Roads (Northern Ireland) Order 1993.

The Department proposes to acquire the lands for the construction of a road 1.6 kilometres in length (part dual carriageway/part motorway) linking the present A26 Ballee Road East dual carriageway underneath the Larne Road roundabout to the southern end of the M2 Ballymena Bypass and the construction of related connector roads.

All documents and maps relating to the Scheme may be inspected and further information relating to the proposals may be obtained by any person, free of charge, at all reasonable hours during the period from 20 September to 27 October 2006 at the offices of the:

- Department for Regional Development, Roads Service - Northern Division, County Hall, Castlerock Road, Coleraine BT52 3HS;
- Department for Regional Development, Roads Service - Northern Division, County Hall, 182 Galgorm Road, Ballymena BT42 1QG;
- Department for Regional Development, Roads Service - Northern Division, Ballymena & Larne Section Office, 190 Larne Link Road, Ballymena BT42 3HA;
- Department for Regional Development, Roads Service - Headquarters, Room 2-01, Clarence Court, 10-18 Adelaide Street, Belfast BT2 8GB; and
- Ballymena Borough Council, Ardeevin, 80 Galgorm Road, Ballymena BT42 1AB.

An electronic version of the Environmental Statement (Non Technical Summary) is available for viewing at [www.drdni.gov.uk/foi](http://www.drdni.gov.uk/foi).

Any person who wishes to express an opinion on the Environmental Statement or to object to the making of the M2/A26 (Ballee Road East link) Order (Northern Ireland) 2006 or the proposed vesting order must, on or before 27 October 2006, write to the Divisional Roads Manager, Department for Regional Development, Roads Service - Northern Division, County Hall, Castlerock Road, Coleraine BT51 3HS, stating their opinion on the Environmental Statement and/or the grounds of their objection.

R. Sherman

A senior officer of the Department  
for Regional Development

15 September 2006

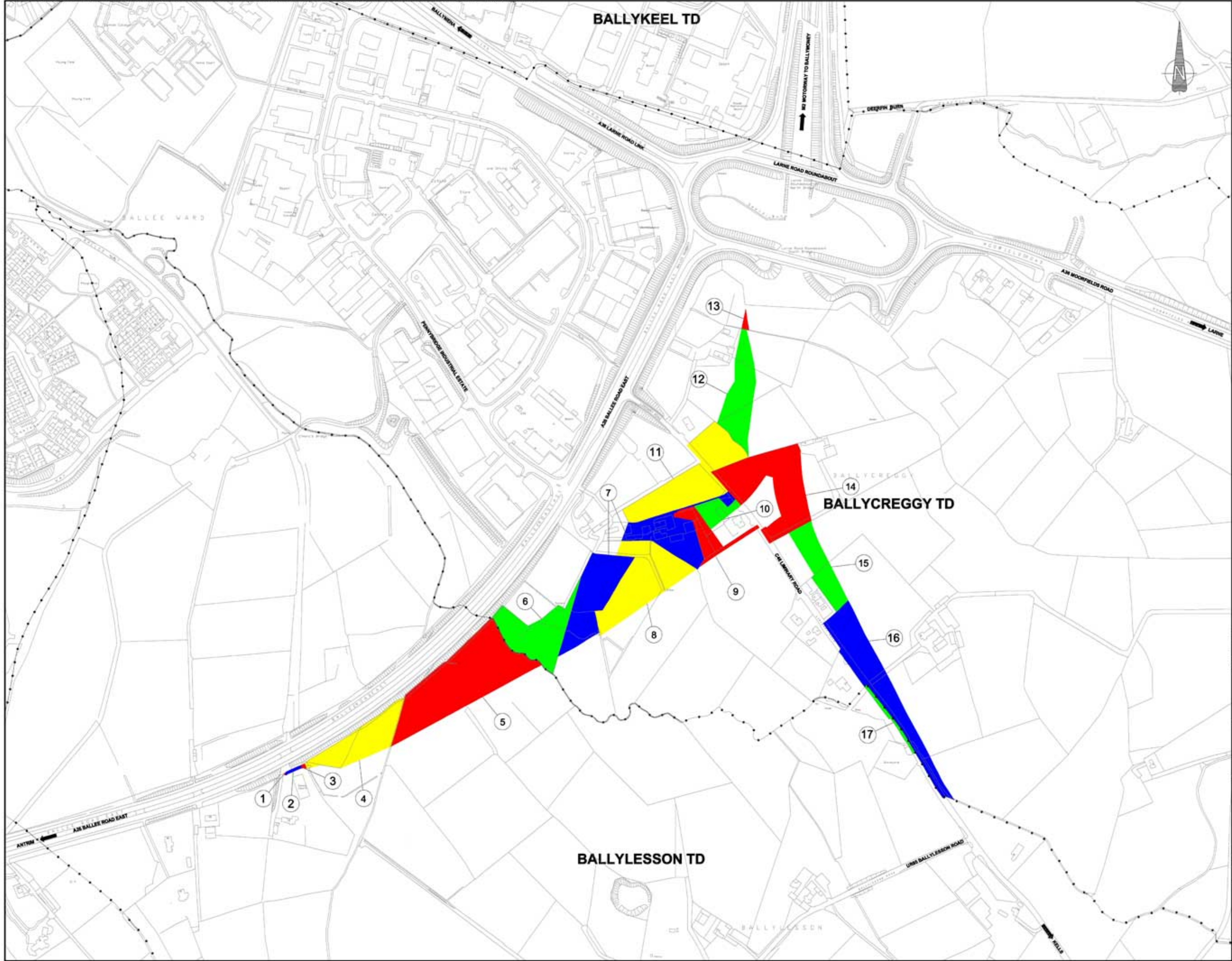

**NOTES**

**LEGEND**  
 - - - - - TOWNLAND BOUNDARY

Based upon the 1/2500 scale map of 2005 by permission of the Ordnance Survey of Northern Ireland on behalf of the Controller of Her Majesty's Stationery Office. © Crown copyright.

OS sheets 06707; 06708; 06711; 06712; 06715; 06716; 06805; 06809; 06813.

F	21/05/06	Revised changed to solid colour; Plots 14 & 15 allocated new colours			
E	24/05/06	Plots 10 & 14 revised			
D	12/06/06	Plots 14, 15, 16 & 17 revised			
C	27/05/06	Plots 5, 7 & 8 revised			
B	11/05/06	Plots revised			
A	09/01/06	Landscaping Areas Added	RG	RG	
Rev	Date	Description	Drawn	Checked	Scale



**Project:**  
 NORTHERN KEY TRANSPORT CORRIDOR:  
 A26 BALLEE ROAD EAST TO  
 M2 BALLYMENA BYPASS DUALLING  
 SCHEME

**LANDPLAN**

Design: CM	CAD: CM
CHK'd: RG	App'd: RG
Date: JAN 2008	Scale: 1:2500

**FABER MAUNSELL | AECOM**  
 349 Bath Street Glasgow G2 3AA  
 Tel: +44 (0) 141 567 7100 Fax: +44 (0) 141 567 7101 www.fabermaunsell.com

No. 04N001/R/M/P/011 **F**