

This material is based upon Crown Copyright & is reproduced with the permission of Land & Property Services under delegated authority from the Controller of Her Majesty's Stationery Office, © Crown Copyright & Data base rights NIWA & ES LA214. Unauthorised reproduction infringes © Crown Copyright & may lead to Prosecution or civil proceedings.

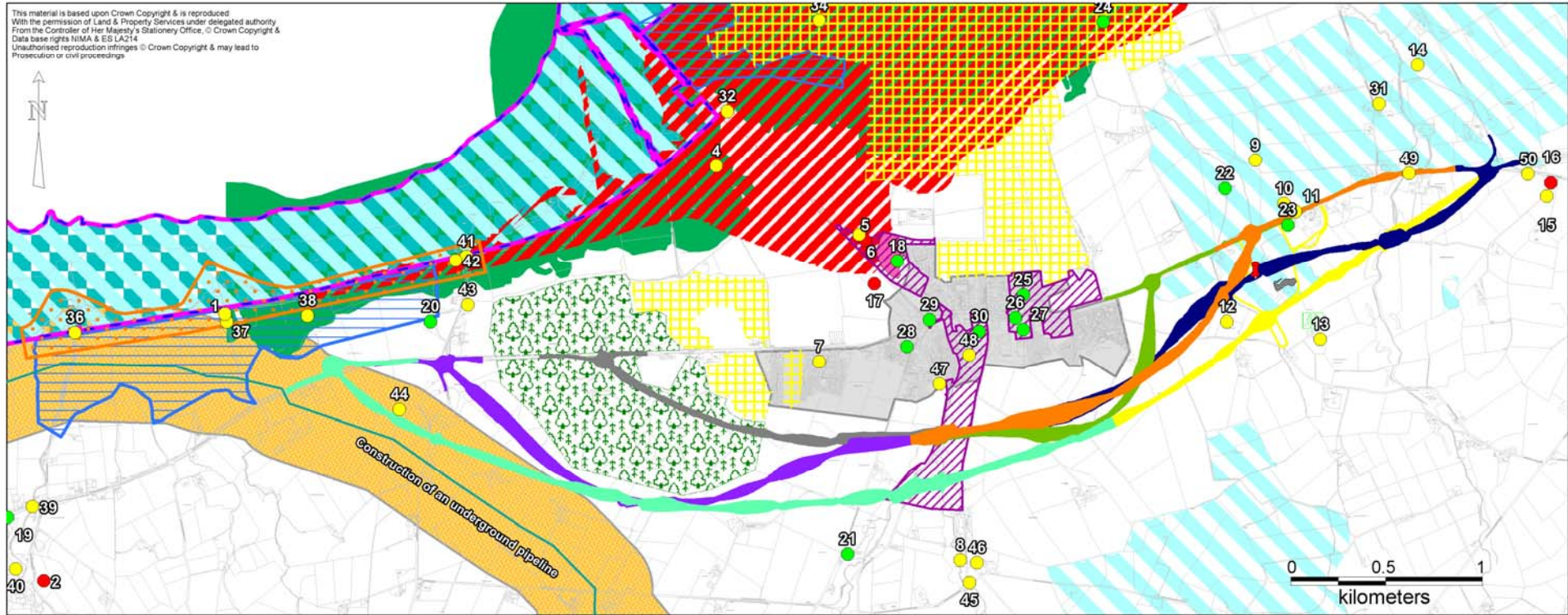

No_	Description	No_	Description	No_	Description
1	Battle Site	20	Carrichue House	39	Bridge
2	Church and Modern Graveyard	21	St Finlocha R C Church	40	Corn and Flax mill Site
3	Standing Stonestone	22	Tamlaught finlagan rectory	41	Bridge
4	Curvilinear field boundary	23	Mansefield House	42	Station
5	Walworth Old Church	24	Aircraft Hangar	43	Corn and Flour Mill Complex
6	A large boulder with a central hollow	25	Church Hill House	44	Old Flax Mill
7	Small, circular cropmark	26	Gate Lodge	45	Sistrakeel Bridge
8	Holy Well (un-located)	27	Presbyterian Church	46	Tannery
9	oval enclosure	28	Glasvey House	47	Corn Mill and Kiln site
10	circular enclosure	29	Bridge House	48	Brick Kilns
11	circular enclosure	30	Presbyterian Manse	49	Glebe/Rascahan
12	oval enclosure	31	Brickfield Brick and Tile works	50	Brickfield
13	enclosure	32	Station, Level Crossing and Bridge		
14	mound	33	Ballykelly Canal		
15	Cist Burials	34	Level Crossing		
16	Counterscarp path: Rough Fort	35	Battle Faughanvale		
17	Plantation village site	36	Bride BNCR Main Line Belfast to C		
18	17th century Bawn	37	Bridge as above		
19	Two storey Georgian style house	38	Salt Pans		

### Legend

- SPA
- ASSI
- RAMSAR
- SLNCl / ACMD
- Ballykelly Forest
- Settlement Development Limit
- LLPA
- Historic Park Garden or Demense
- Previous Ministry of Defence Site
- Coastal Flooding
- Historic Flooding (River)
- Historic Flooding
- Q 100 Yr Predictive Flooding
- Indicative Area of Tar Pool
- Indicative Area of Birds Foot (Ornithopus Perpusillus)
- O2 Phone Mast
- 300m Buffer of Proposed Gas Pipeline
- Cultural Heritage: Battle Site

### Known Archaeology

- Scheduled Monument
- Archaeological Monument
- Listed Building
- Unknown
- Proposed Grey Option
- Proposed Turquoise Option
- Proposed Purple Option
- Proposed Orange Option
- Proposed Olive Option
- Proposed Navy Option
- Proposed Yellow Option

Client: An Agency within the Department for Regional Development

Project: **A2 Ballykelly Bypass : Stage Two**

Title: **Figure 2.1 Environmental Constraints Map**

24 Linenhall Street  
Belfast  
BT2 8BG

Tel: +44 (0) 28 9060 7200  
Fax: +44 (0) 28 9060 7399  
www.aecom.com

Design: PG	Mapinfo: PG
Chk'd: CD	App'd: TMcK
Date: 25/03/2010	Scale: NTS Print @ A3
No. 60098645	